



Tuya App Manual

—Without fingerprint—

- 1 Scan QR code to download Tuya APP or Search Tuya on App store to download it.



or



Scan QR code

Search TuyaSmart to download APP

2

Open Tuya APP to add new equipment

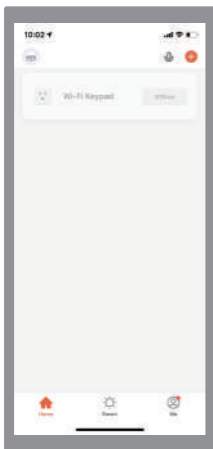

3

Select "Auto scan", click "Searching"



4

Connect with available devices, click “Next”.

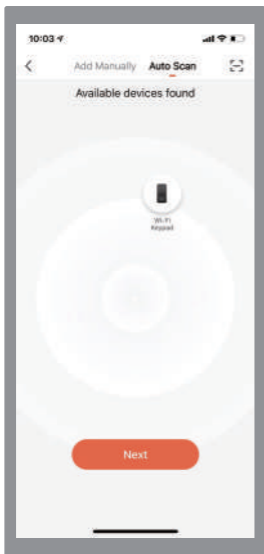

5

Choose Wi-Fi and enter password, click “Next”.

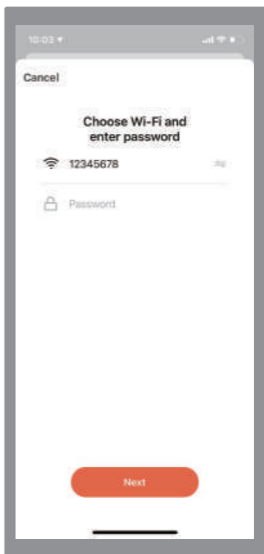

6 Connecting, Added successfully, click “Done”.

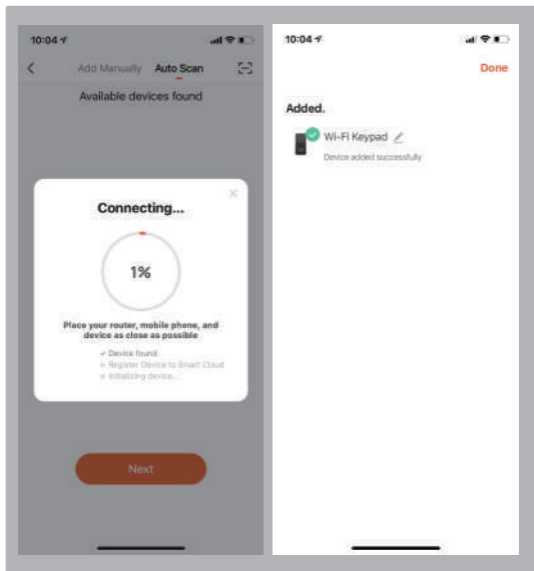

7 Click setting, open remote unlock setting

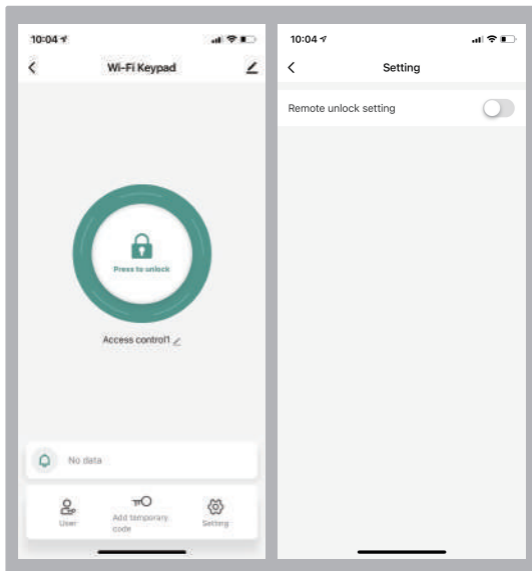

8 Press to unlock

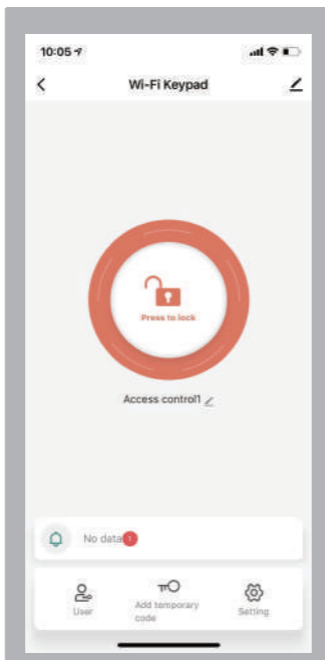

- 9 Select user, click “+” to add user, fill in name, click next step, then click “Add” to input 6 digits code or generated code randomly , fill in code name or card name, click “Save “.

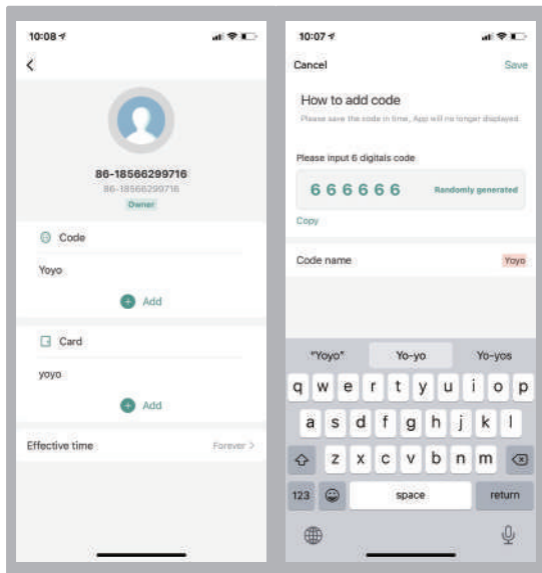

10 Add card by clicking start add

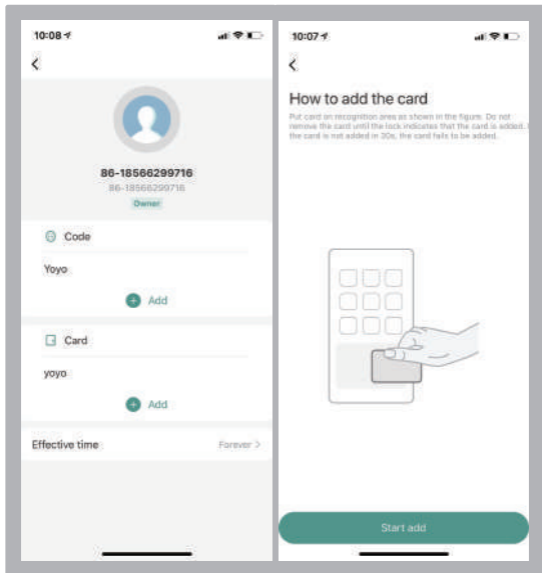

- 11 swiping one card within 60 seconds, add card successfully, then fill card name and click “Done” .

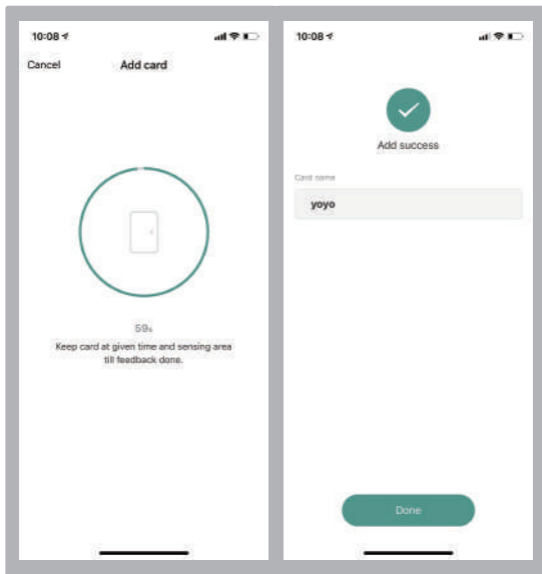

- 12 Add ordinary user by clicking ordinary member “+”



13 then input the related information and click “Next step”.

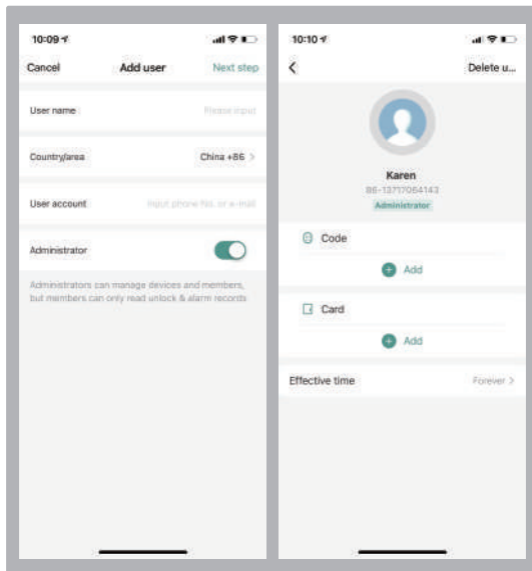

- 14 Add code user by clicking add temporary code cyclicly, and inputting six digits code or clicking randomly generated, then input code name.

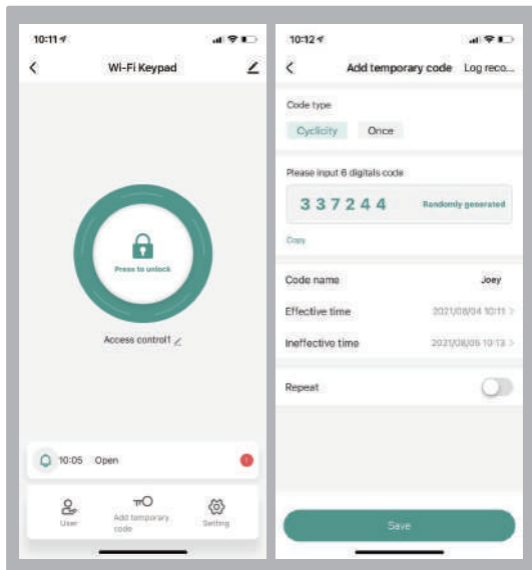

- 15 Set effective time and ineffective time, click “Save”.

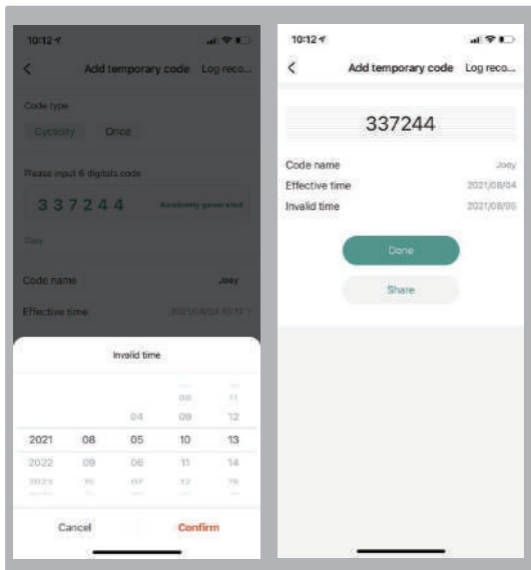

- 16 Add temporary code,click “Once”,input code name, click “Save offline code”, Done
Notice: The code valid time for 6 hours and only can be used once.

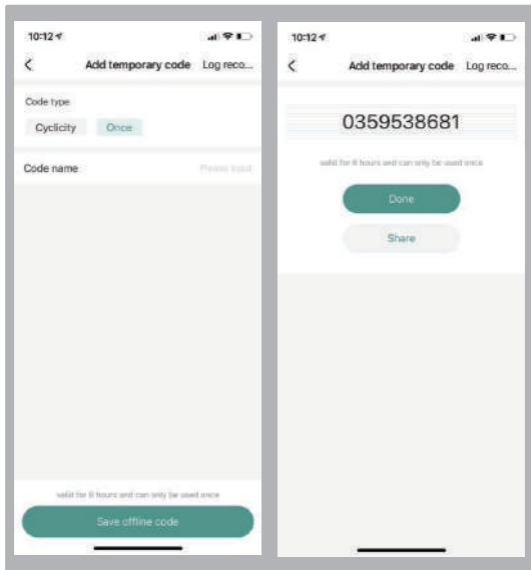

17 Door opening record check

