



Video Intercom Access Control

Tuya App Manual

Mobile phone remote function

- 1 Scan QR code to download Tuya APP or Search Tuya on App store to download it.



Scan QR code





Search Tuya Smart to download APP



- 2 Open Tuya App to add new equipment

Note: When searching for devices, firstly turn on the WIFI, Bluetooth and Location on your phone.

Press  **Master code**  **08** on the access control Keypad for WIFI matching.

- 3 Choose Wi-Fi and enter password, click”Next”.

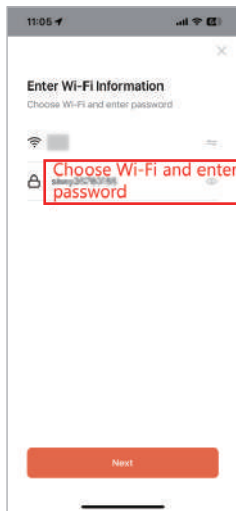
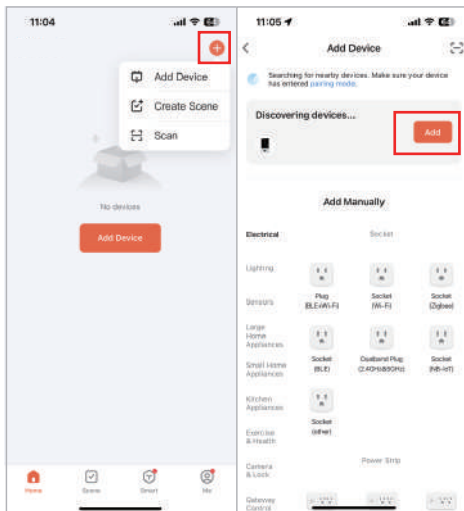

- 4 Connecting, Added successfully, click "Done".

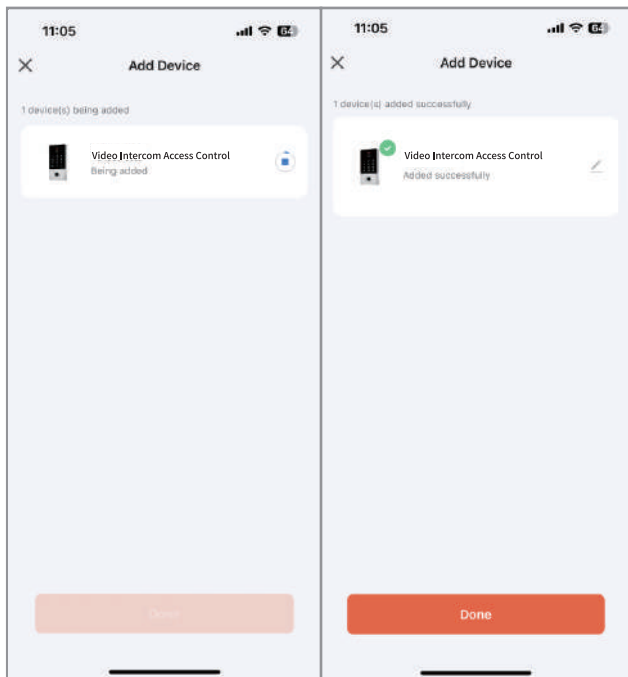

- 5 Click setting, open remote unlock setting.

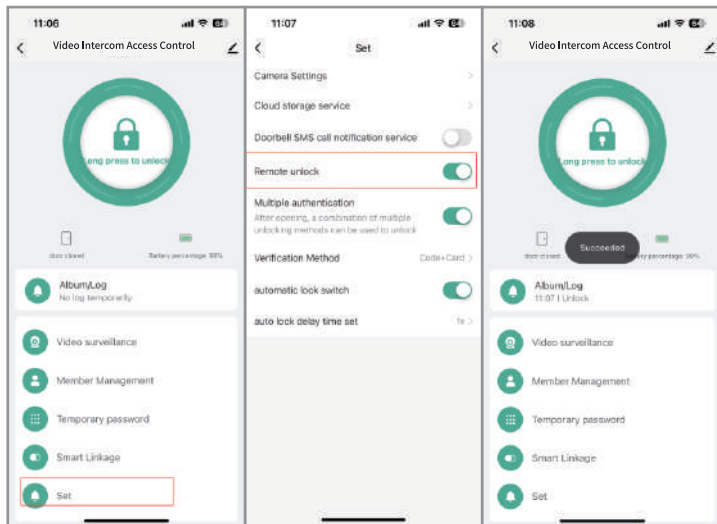

- 6 **Video Surveillance** : View visitors via mobile phone monitoring. Can set the sound turn on or off, take pictures, record videos, support intercom, and remote unlock.

- 7 **Press to unlock**

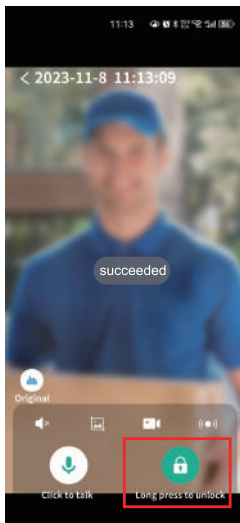
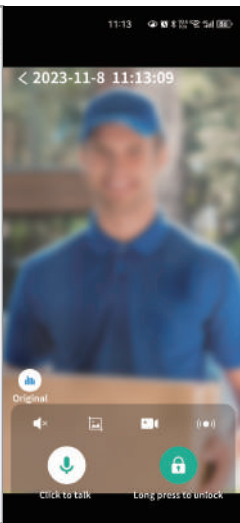
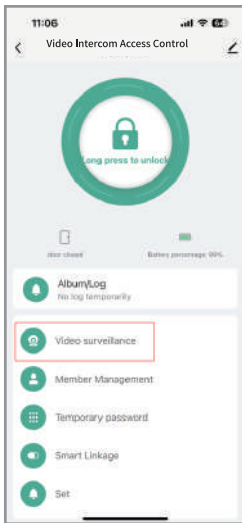

Icon function notes:

🔊× Sound turn on/off

📷 Photograph

📹 Video record

🔊 Set the sound mode (multiple sound modes are available: Original, Robot, Miss, Boy, Uncle)

- 8 Member Management → Click User → click “Add” to add fingerprint
→ Start to add → register fingerprint twice
Add successfully, fill in name, click “Done”.

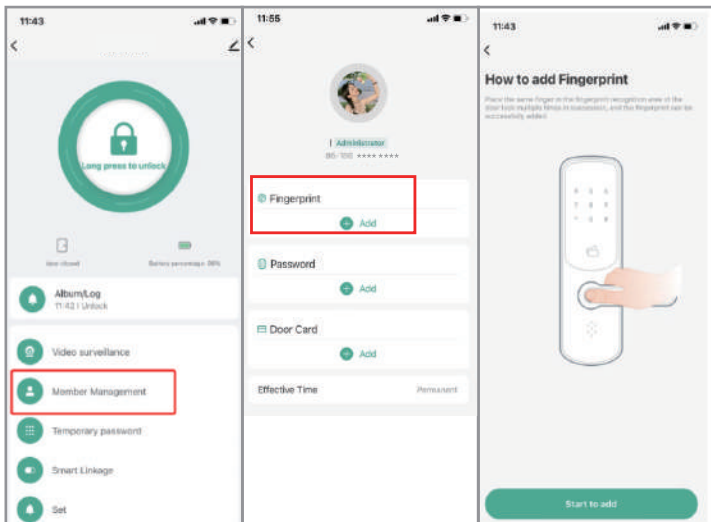

- 9 Add password by inputting 6 digits code or clicking generated code randomly, and fill in code name, then click "Save".
- 10 Add card by clicking start to add, swipe one card within 60 seconds, add card successfully, then fill in card name and click "Done".

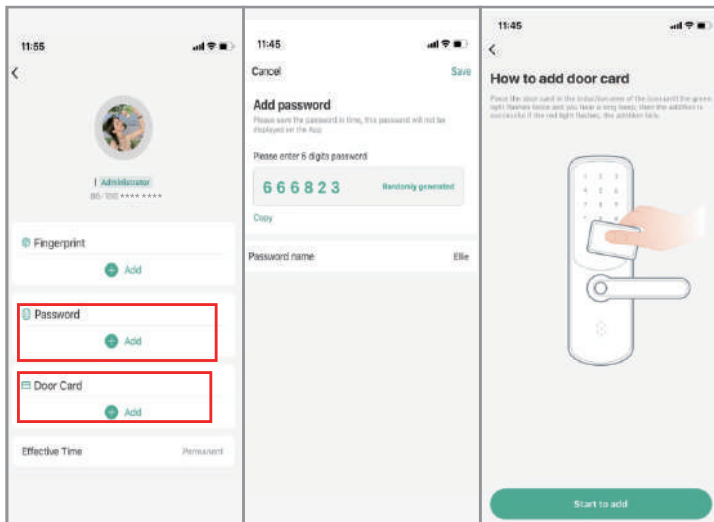

- 11 Add Other Member by clicking “+”, then choose “Other members”, then input the related information and click “Next step”.

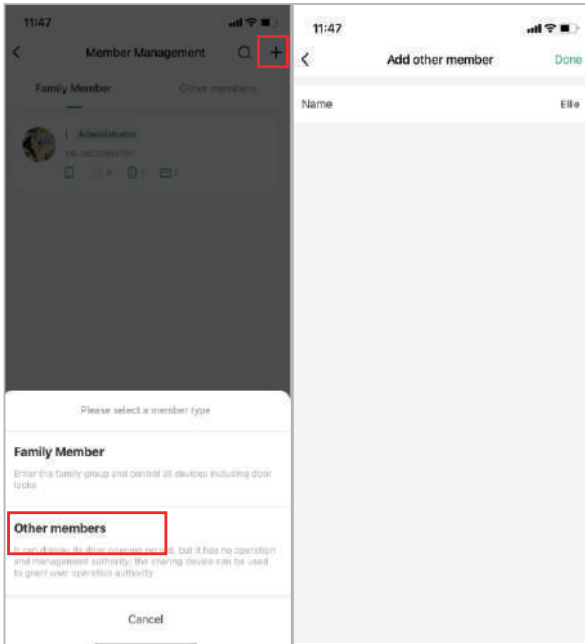

- 12 Add Temporary code by clicking Add Temporary Password “Limited time”, add effective time,invalid time and password name, then click “Get Password”, then click “Done”.

The image displays two sequential screenshots of a mobile application interface for adding a temporary password.

Left Screenshot: The screen is titled "Add temporary password" with a "Record" button in the top right. Under the "Password Type" section, three options are visible: "Limited time" (highlighted with a red box), "single time", and "Empty". Below this, there are fields for "effective time" (2023/11/30 11:00 >), "Invalid Time" (2023/11/30 12:00 >), and "Password name" (Ellipsis). A "Custom" button is also present. At the bottom, a green button labeled "Get password" is visible, along with a note: "Use at least once within 24 hours after it takes effect, otherwise it will be invalid".

Right Screenshot: The screen shows the generated password "9394683545" in a large font. Below the password is a "Copy" button. The "effective time" is 2023-11-30 11:00 and the "Invalid Time" is 2023-11-30 12:00. The "Password name" is "Ellipsis". A note states: "Use at least once within 24 hours after it takes effect, otherwise it will be invalid". A green button labeled "Done" is at the bottom.

Notice: “Custom” password type can set Password Name, Effective Time and Repeat Valid Time.

- 13 Add a guest password, select Custom, fill in password name, click Get Password, and done.

The image displays two sequential screenshots of an iOS application interface for adding a temporary password.

Left Screenshot: The screen is titled "Add temporary password". Under "Password Type", the "Custom" option is selected and highlighted with a red box. Below this, a text field contains the password "656430" with a "Randomly generated" label. The "effective time" is 2023/12/01 16:31 and the "Invalid Time" is 2023/12/31 16:31. The "Password name" is "Liu". The "Repeat" toggle is turned on. The "Start Time" is 16:34 and the "End Time" is 18:00. A "Save" button is at the bottom.

Right Screenshot: The screen shows the same information as the left screenshot, but with a large green "Done" button at the bottom.

Note: Guest password can only be used once and is valid for 6 hours.

14 Smart Linkage

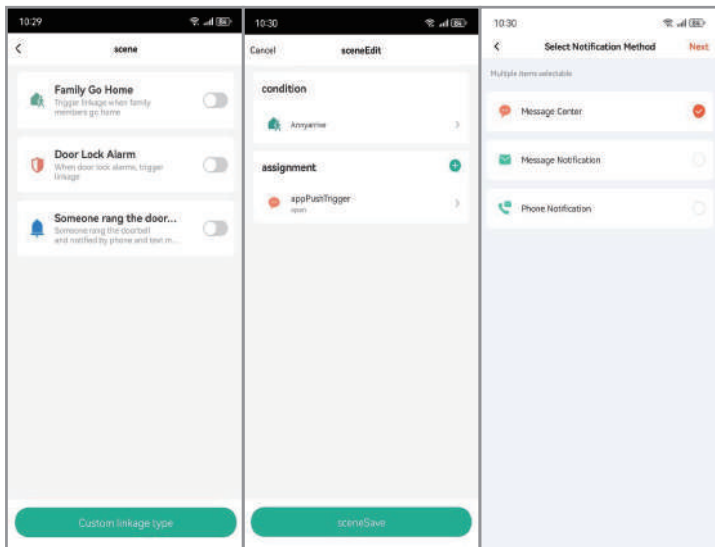

Note: SMS Notification and PhoneNotification will be charged

- 15 Open door record query: click on the Album/Log, click log, click door opening record

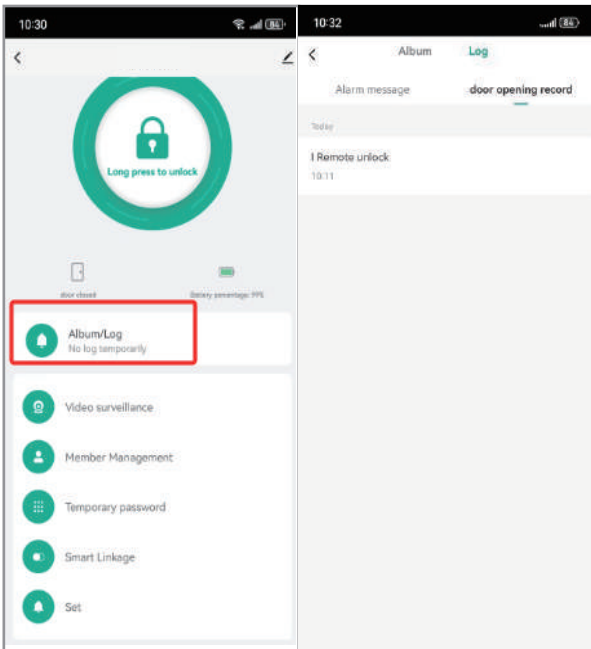

16 Settings: Intercom mode, Remote unlock, Auto lock delay time set.

